

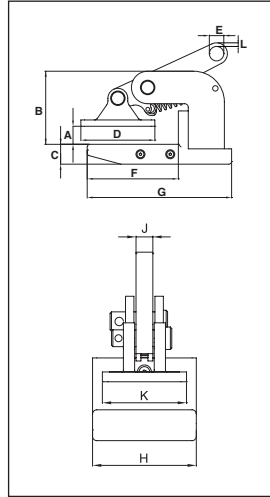

IPHNM10

The IPHNM10 horizontal lifting clamps have a pretension feature that allows the user to attach the clamps to the material for horizontal lifting and transfer of non-sagging material. To be used where material surface must not be damaged. These clamps must be used in pairs or more.



IPH10

The IPH10 horizontal lifting clamps with spring loaded tension have a pretension feature that allows the user to attach the clamps to the material for horizontal lifting and transfer of non-sagging material. These clamps must be used in pairs or more.

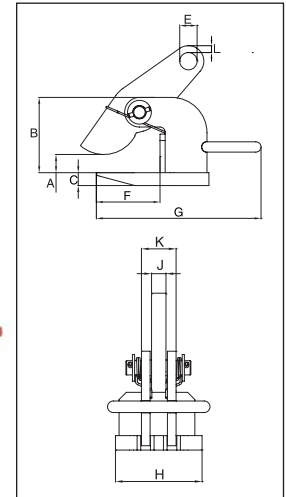

For Horizontal Lift and Transfer with Pretension System

- Available in capacities of .5 thru 12 metric tons.
- Jaw openings available: 0" to 4.75".
- Welded alloy steel body for strength and smaller size. Forged alloy components, where required.
- Individually Proof Tested to 2 times the Working Load Limit with certification.
- Company name (CrosbyIP), logo, Working Load Limit and jaw opening permanently stamped on body.
- Each product is individually serialized, with the serial number and Proof Load test date stamped on body. User manual with test certificate is included with each clamp.
- Maintenance and repair kits are available.
- Manufactured by an ISO 9001 facility.
- All sizes are **RFID EQUIPPED**.



Load Rated

Model IPHNM10

Model	Working Load Limit (Per Pair) (t)*	IPHNM10 Stock No.	Weight Each (lbs.)	Dimensions (in.)										
				Jaw A	B	C	D	E	F	G	H	J	K	L
IPHNM10	.5	2703287	8.00	0 - 0.81	3.19	0.87	3.23	0.63	3.98	6.30	2.91	0.47	2.36	0.16
IPHNM10	1	2703288	14.0	0 - 1.38	3.66	1.18	3.62	0.63	4.06	6.46	2.91	0.47	2.36	0.28
IPHNM10	2	2703290	32.0	0 - 1.18	5.47	1.18	5.16	0.87	6.54	9.65	3.94	0.79	2.91	0.35
IPHNM10J	2	2703291	34.0	1.19 - 2.38	6.65	1.18	5.16	0.87	6.54	9.65	3.94	0.79	2.91	0.35

* Design Factor based on EN 13155 and ASME B30.20.

Model IPH10 and IPH10J: With Spring Loaded Tension, Magnets and Handle

Model	Working Load Limit (Per Pair) (t)*	IPH10 Stock No.	Weight Each (lbs.)	Dimensions (in.)										
				Jaw A	B	C	E	F	G	H	J	K	L	
IPH10	.5+	2703297	3.97	0 - 0.81	3.39	0.47	0.63	4.06	5.91	2.36	0.47	1.06	0.16	
IPH10	1+	2703298	5.50	0 - 1.38	3.94	0.63	0.63	4.06	5.91	2.36	0.47	1.22	0.28	
IPH10	2	2703522	24.3	0 - 2.38	4.61	0.63	0.87	4.29	10.08	4.33	0.79	1.57	0.35	
IPH10	3	2703523	33.1	0 - 2.38	4.61	0.79	1.02	4.29	10.47	4.72	0.79	1.89	0.43	
IPH10	4.5	2703524	46.3	0 - 2.38	5.20	0.98	1.18	4.09	11.02	5.12	0.79	1.89	0.47	
IPH10	6	2703525	57.3	0 - 2.38	5.63	0.98	1.42	4.84	12.60	5.12	0.79	1.89	0.55	
IPH10	9	2703526	81.6	0 - 2.38	6.18	1.18	1.69	5.24	12.99	5.51	0.98	2.44	0.63	
IPH10	12	2703527	94.8	0 - 2.38	6.77	1.18	1.85	5.55	13.90	5.91	0.98	2.44	0.67	
With larger jaw opening #														
IPH10J	3	2703533	38.0	2.38 - 4.75	6.97	0.79	1.02	4.29	10.47	4.72	0.79	1.89	0.35	
IPH10J	4.5	2703534	52.0	2.38 - 4.75	7.56	0.98	1.18	4.09	11.02	5.12	0.79	1.89	0.43	
IPH10J	6	2703535	66.0	2.38 - 4.75	7.99	0.98	1.42	4.84	12.60	5.12	0.79	1.89	0.47	
IPH10J	9	2703536	90.0	2.38 - 4.75	8.54	1.18	1.69	5.24	12.99	5.51	0.98	2.44	0.55	
IPH10J	12	2703537	90.0	2.38 - 4.75	9.13	1.18	1.85	5.55	13.90	5.91	0.98	2.44	0.63	

* Design Factor based on EN 13155 and ASME B30.20. + No handle or magnets. # Larger Working Load Limits available.

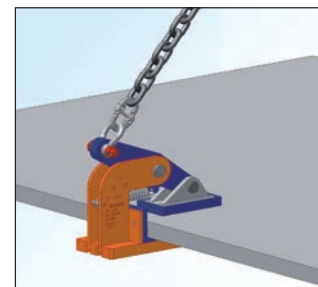
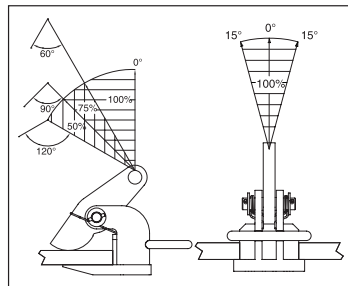
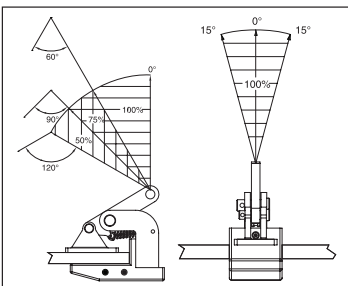

Horizontal Clamps



IPH10E

The IPH10E / IPH10JE horizontal lifting clamps are for use in the lifting and transfer in horizontal position of non-sagging materials or of bundles of non-sagging material. These clamps must be used in pairs or more.

For horizontal lifting and transfer

- Available in capacities of 2.0 thru 25 metric tons.
- Wide variety of jaw openings available: 0 to 4.72”
- Welded alloy steel body for strength and smaller size. Forged alloy, components where required.
- Equipped with handle for easy placement.
- Individually Proof Tested to 2 times the Working Load Limit with certification.
- Company name (CrosbyIP), logo, Working Load Limit and jaw opening permanently stamped on body.
- Each product is individually serialized, with the serial number and Proof Load test date stamped on body. User manual with test certificate is included with each clamp.
- Maintenance and repair spare kits are available.
- Manufactured by an ISO 9001 facility.
- All sizes are **RFID EQUIPPED**.

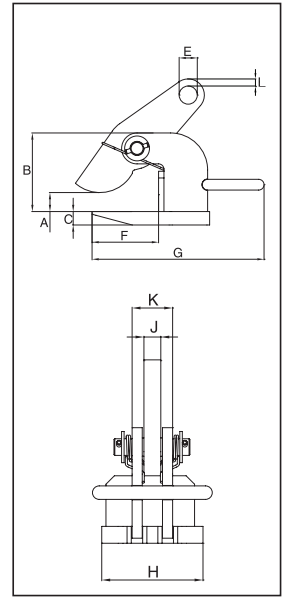

Model IPH10E: Jaw opening range 0 to 2.38”

Model	Working Load Limit (Per Pair) (t)*	IPH10E Stock No.	Weight Each (lbs.)	Dimensions (in.)									
				Jaw A	B	C	E	F	G	H	J	K	L
IPH10E	2	2703542	24.0	0 - 2.38	4.61	0.63	0.87	4.29	10.08	4.33	0.79	1.57	0.35
IPH10E	3	2703543	32.0	0 - 2.38	4.61	0.79	1.02	4.29	10.47	4.72	0.79	1.89	0.43
IPH10E	4.5	2703544	46.0	0 - 2.38	5.20	0.98	1.18	4.09	11.02	5.12	0.79	1.89	0.47
IPH10E	6	2703545	56.0	0 - 2.38	5.63	0.98	1.42	4.84	12.60	5.12	0.79	1.89	0.55
IPH10E	9	2703546	80.0	0 - 2.38	6.18	1.18	1.69	5.24	12.99	5.51	0.98	2.44	0.63
IPH10E	12	2703547	94.0	0 - 2.38	6.77	1.18	1.85	5.55	13.90	5.91	0.98	2.44	0.67
IPH10Z	25	2705119	86.0	0 - 2.38	6.65	1.57	1.85	6.69	11.81	8.66	1.26	4.45	.85

* Design Factor based on EN 13155 and ASME B30.20.

Model IPH10JE: Jaw opening range 2.36 to 4.72”

Model	Working Load Limit (Per Pair) (t)*	IPH10JE Stock No.	Weight Each (lbs.)	Dimensions (in.)									
				Jaw A	B	C	E	F	G	H	J	K	L
IPH10JE	3	2703553	38.0	2.38 - 4.75	6.97	0.79	1.02	4.29	10.47	4.72	0.79	1.89	0.43
IPH10JE	4.5	2703554	52.0	2.38 - 4.75	7.56	0.98	1.18	4.09	11.02	5.12	0.79	1.89	0.47
IPH10JE	6	2703555	66.0	2.38 - 4.75	7.99	0.98	1.42	4.84	12.60	5.12	0.79	1.89	0.55
IPH10JE	9	2703556	90.0	2.38 - 4.75	8.54	1.18	1.18	5.24	12.99	5.51	0.98	2.44	0.63
IPH10JE	12	2703557	104.0	2.38 - 4.75	9.13	1.18	1.85	5.55	13.90	5.91	0.98	2.44	0.67

* Design Factor based on EN 13155 and ASME B30.20.

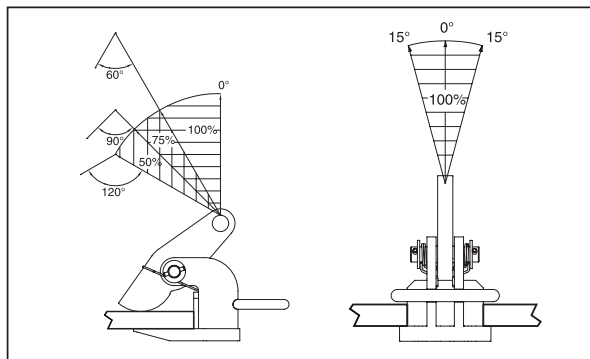



IPHOZ

The IPHOZ horizontal lifting clamp is to be used for lifting and transferring, in the horizontal position, of thin sheet and other materials that will sag or bend when lifted. These clamps must be used in pairs or more.

For Horizontal Lifting and Transfer

- Available in capacities of .75 thru 15 metric tons.
- Wide variety of jaw openings available: 0" to 2.36".
- Welded alloy steel body for strength and smaller size. Forged alloy, components where required.
- Equipped with handle for easy placement.
- Individually Proof Tested to 2 times the Working Load Limit with certification.
- Company name (CrosbyIP), logo, Working Load Limit and jaw opening permanently stamped on body.
- Each product is individually serialized, with the serial number and Proof Load test date stamped on body. User manual with test certificate is included with each clamp.
- Maintenance and repair kits are available.
- Manufactured by an ISO 9001 facility.
- All sizes are **RFID EQUIPPED**.

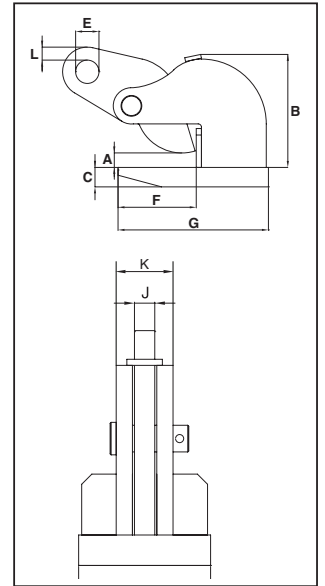

Load Rated®

Model IPHOZ: Jaw opening range 0 to 2.36"

Model	Working Load Limit (Per Pair) (t)*	IPHOZ Stock No.	Weight Each (lbs.)	Dimensions (in.)									
				Jaw A	B	C	E	F	G	H	J	K	L
IPHOZ	0.75	2705401	12.0	0 - 1.19	3.70	0.63	0.63	2.76	4.65	3.19	0.47	1.22	0.47
IPHOZ	1.5	2705402	24.0	0 - 1.75	5.24	0.63	0.87	4.92	7.56	3.94	0.63	1.42	0.47
IPHOZ	3	2705403	34.0	0 - 1.75	5.39	0.79	1.02	4.92	7.87	4.72	0.79	1.89	0.39
IPHOZ	4.5	2705404	36.0	0 - 1.75	5.43	0.98	1.18	4.96	8.66	4.72	0.79	1.97	0.39
IPHOZ	6	2705405	68.0	0 - 2.38	6.73	1.18	1.42	5.31	9.25	5.12	0.79	2.20	0.79
IPHOZ	9	2705406	90.0	0 - 2.38	8.31	1.18	1.69	6.54	10.87	6.30	0.98	2.44	0.79
IPHOZ	12	2705407	122	0 - 2.38	8.54	1.57	1.85	6.61	11.57	7.48	0.98	2.44	0.75
IPHOZ	15	2705408	158	0 - 2.38	8.66	1.57	1.85	7.20	12.48	9.84	0.98	2.44	0.87

* Design Factor based on EN 13155 and ASME B30.20.

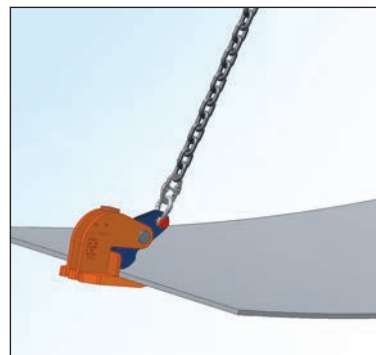
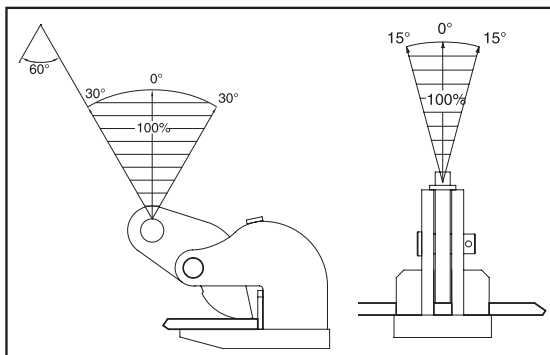

Horizontal Clamps



IPBC

The IPBC horizontal lifting clamps have a pretension feature that allows the user to attach the clamps to the material for horizontal lifting and transfer of sagging and non-sagging material. These clamps may also be used to handle material that will be used in shears, bending and rolling machines or other fabrication equipment. May also be used for turning beams from the "H" position.

For Horizontal Transfer - with Pretension System

- Available in capacities of 1 thru 4.5 metric tons.
- Jaw openings available: 0" to 1.57".
- Welded alloy steel body for strength and smaller size. Forged alloy, components where required.
- Equipped with handle for easy placement.
- Individually Proof Tested to 2 times the Working Load Limit with certification.
- Company name (CrosbyIP), logo, Working Load Limit and jaw opening permanently stamped on body.
- Each product is individually serialized, with the serial number and Proof Load test date stamped on body. User manual with test certificate is included with each clamp.
- Maintenance and repair kits are available.
- Manufactured by an ISO 9001 facility.
- All sizes are **RFID EQUIPPED**.



IPHGZ

The IPHGZ, IPHGUZ horizontal lifting clamps have a pretension locking feature that allows the user to attach the clamps to the material for horizontal lifting and transfer of sagging and non-sagging material. These clamps may also be used to handle material that will be used in shears, bending and rolling machines or other fabrication equipment. May also be used to move and lift structural shapes such as I-Beams, H-beams etc.



Load Rated

Model IPBC

Model	Working Load Limit (t)*	IPBC Stock No.	Weight Each (lbs.)	Dimensions (in.)									
				Jaw A	B	C	E	F	G	H	J	K	L
IPBC	1	2700410	7.72	0 - 0.81	5.20	2.05	1.02	2.95	7.28	1.42	0.63	7.17	0.47
IPBC	2	2700411	14.3	0 - 1.00	5.98	2.44	1.18	3.23	8.27	1.93	0.79	8.58	0.59
IPBC	3	2700412	18.8	0 - 1.00	6.18	2.60	1.18	3.23	8.27	2.24	0.79	8.86	0.59

* Design Factor based on EN 13155 and ASME B30.20.

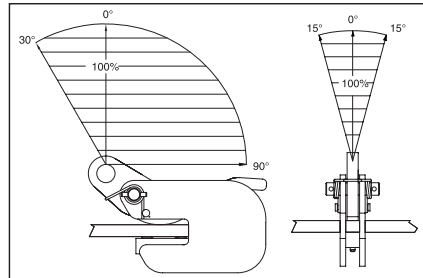
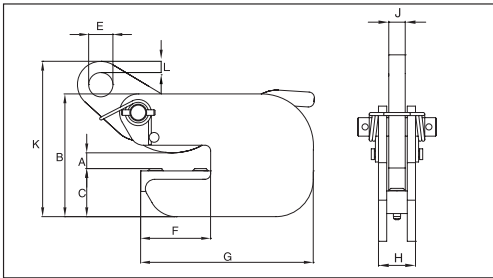

Model IPHGUZ: Universal Lifting Eye / Model IPHGZ: Fixed Hoisting Eye

Model	Working Load Limit (t)*	IPHGZ Stock No.	Weight Each (lbs.)	Dimensions (in.)								
				Jaw A	B	C	D	E	F	G	J	K
IPHGUZ	1.5	2705455	19.8	0 - 1.00	4.33	9.13	11.30	2.76	5.47	3.54	0.79	0.63
IPHGUZ	3.0	2705456	43.9	0 - 1.56	4.69	9.96	13.70	2.95	6.89	4.72	0.98	0.79
IPHGUZ	4.5	2705457	66.1	0 - 1.56	4.69	11.85	14.57	3.15	6.89	6.10	1.18	1.73
Fixed Hoisting Eye												
IPHGZ	.75	2705451	8.82	0 - 1.00	3.23	5.83	8.11	1.97	3.90	3.86	0.47	0.87
IPHGZ	1.5	2705452	4.41	0 - 1.00	4.33	7.87	9.84	1.97	4.65	3.54	0.79	1.10
IPHGZ	3.0	2705453	27.1	0 - 1.56	4.72	8.94	12.01	2.76	5.83	4.72	0.98	1.26
IPHGZ	4.5	2705454	55.1	0 - 1.56	4.72	11.18	15.00	2.76	7.13	6.10	1.18	1.57

* Design Factor based on EN 13155 and ASME B30.20.

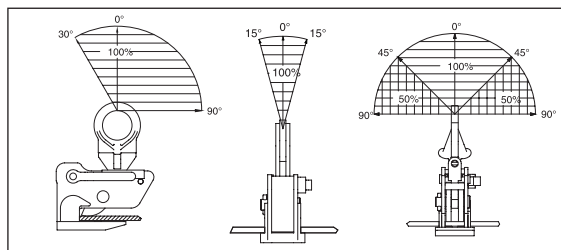
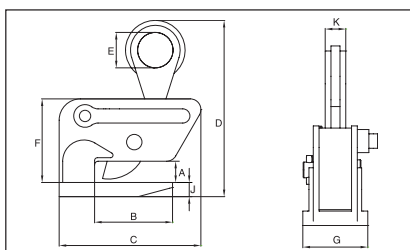



NEW

IPPE10B(E)

The IPPE10 type clamp is suitable for lifting and transferring bundles of non-bendable sheets of metal in a horizontal position. The jaw opening can be easily adjusted for the height of the bundle or plate. The IPPE10 has magnets in the footplate. This allows one person to operate multiple clamps at the same time when lifting loads.

For lifting and transporting non-bendable sheet metal in a horizontal position.

- Available in capacities of 3 thru 12 metric tons.
- Wide variety of jaw openings available: 0 to 7.09”
- Welded alloy steel body for strength and smaller size. Forged alloy components, where required.
- Individually Proof Tested to 2 times the Working Load Limit with certification.
- Company name (CrosbyIP), logo, Working Load Limit and jaw opening permanently stamped on body.
- Each product is individually serialized, with the serial number and Proof Load test date stamped on body. User manual with test certificate is included with each clamp.
- Maintenance and repair kits are available.
- Manufactured by an ISO 9001 facility.
- All sizes are **RFID EQUIPPED**.
- IPPE10B: Magnets in foot plate (also applies for D and H Type).
- IPPE10BE: Economic version (also applies for D and H-Type).
- IPPE10BNM: Non-marring (also applies for D and H-Type).



NEW

IPPE10BNM

The IPPE10BNM lifting clamps may be used for virtually all applications, where the objects that are to be lifted or transported require optimal protection against surface damage. This also applies to materials with a very smooth surface, composites, plates with a protective cover or hard surface plates.

These clamps have to be used in pairs.



Load Rated

Model IPPE10B / IPPE10BE / IPPE10BNM

Model	IPPE Stock No.	Working Load Limit (Per Pair) (t)*	Weight Each (lbs.)	Dimensions (in)									
				Jaw A	B	C	D	E	F	G	H	J	L
3 IPPE10B	2703862	3.0	50.0	0 - 7.13	8.03	12.68	0.79	1.02	2.60	0.79	3.94	1.97	0.59
6 IPPE10B	2703871	6.0	70.0	0 - 7.13	8.66	13.39	0.98	1.18	2.91	0.79	5.51	2.36	0.51
9 IPPE10B	2703888	9.0	108	0 - 7.13	9.76	14.37	0.98	1.34	3.54	0.79	7.48	2.76	0.51
12 IPPE10B	2703921	12.0	144	0 - 7.13	9.92	14.80	1.18	1.57	3.54	0.98	7.87	2.76	0.71
3 IPPE10BE	2703863	3.0	94	0 - 7.13	8.03	12.68	0.79	1.02	2.60	0.79	3.94	1.97	0.59
6 IPPE10BE	2703870	6.0	70	0 - 7.13	8.66	13.39	0.98	1.18	2.91	0.79	5.51	2.36	0.51
9 IPPE10BE	2703891	9.0	108	0 - 7.13	9.76	14.37	0.98	1.34	3.54	0.79	7.48	2.76	0.51
12 IPPE10BE	2703924	12.0	144	0 - 7.13	10.31	14.80	1.18	1.57	3.54	0.98	7.87	2.76	0.71
3 IPPE10BNM	2703864	3.0	54	0 - 7.13	8.03	12.68	1.18	1.02	2.68	0.79	3.94	1.97	0.59
6 IPPE10BNM	2703872	6.0	76	0 - 7.13	8.66	13.39	1.38	1.18	2.99	0.79	5.51	2.36	0.51
9 IPPE10BNM	2703894	9.0	122	0 - 7.13	9.76	14.37	1.38	1.34	3.62	0.79	7.48	2.76	0.51
12 IPPE10BNM	2703927	12.0	154	0 - 7.13	10.31	14.80	1.57	1.57	3.62	0.98	7.87	2.76	0.59

* Design Factor based on EN 13155 and ASME B30.20. Also available in D-Type (maximum jaw opening of 11.75”) and H-Type (maximum jaw opening of 16.50”).

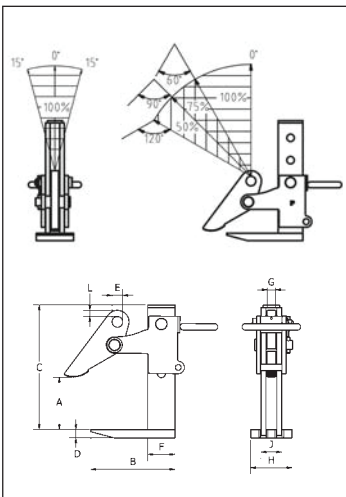

IPPE10(E)

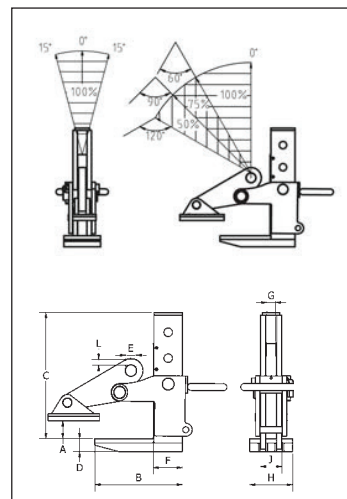
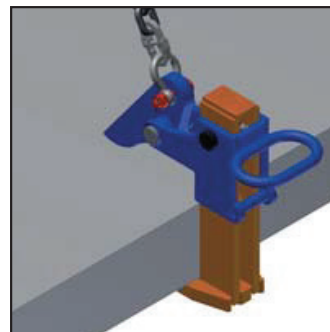

IPPE10NM

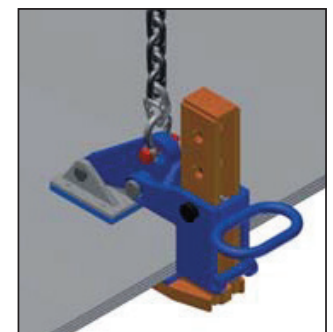



For Lifting and Transferring Steel Beams

- Available in capacities of 1.5 and 2.5 metric tons.
- Jaw openings available: .24" to .79".
- Welded alloy steel body for strength and smaller size. Forged alloy, components where required.
- Equipped with handle for easy placement.
- Individually Proof Tested to 2 times the Working Load Limit with certification.
- Company name (CrosbyIP), logo, Working Load Limit and jaw opening permanently stamped on body.
- Each product is individually serialized, with the serial number and Proof Load test date stamped on body. User manual with test certificate is included with each clamp.
- Maintenance replacement parts are available.
- Manufactured by an ISO 9001 facility.
- All sizes are **RFID EQUIPPED**.

IPSTARTEC11

The IPSTARTEC11 beam clamp has been specially developed for lifting with the body in vertical position, controlled tilting, transportation and stacking of steel "H" and "I" profiles. By placing the chain guide in the appropriate position, it is easy to switch from lifting to tilting and back again, which shifts the center of gravity.

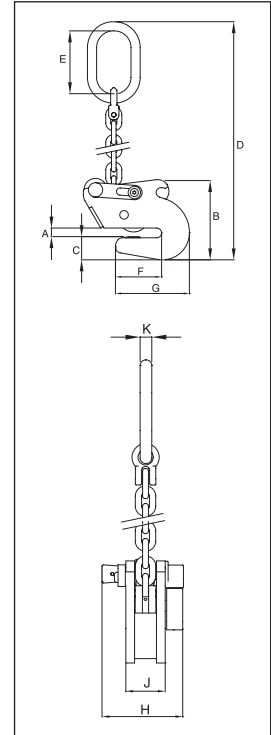

Load Rated

Model IPSTARTEC11

Model	Working Load Limit (t)*	IPSTARTEC11 Stock No.	Weight Each (lbs.)	Dimensions (in.)									
				Jaw A	B	C	D	E	F	G	H	J	K
IPSTARTEC11	1.5	2701812	14.6	0.25 - 0.50	5.51	1.54	22.64	4.33	3.19	5.08	2.13	4.96	0.63
IPSTARTEC11	2.5	2701822	32.0	0.25 - 0.75	8.27	2.17	28.54	5.31	4.53	7.17	2.91	5.51	0.71

* Design Factor based on EN 13155 and ASME B30.20.

